

P.C.B. RECOMMEND LAYOUT
(BOTTOM VIEW)

NOTES:

1. MATERIAL
HOUSING : THERMOPLASTIC, GLASS FIBER FILLED
UL 94V-0 RATED.
CONTACT : PHOSPHOR BRONZE
SHIELD : BRASS
GROUNDING: STAINLESS STEEL
2. FINISH
CONTACT : UNDER PLATED 50 μ MIN. NICKEL COVER ALL
120 μ MIN. TIN IN SOLDERING AREA
SELECTIVE GOLD PLATED IN CONTACT AREA.
SHIELD : (L) BRIGHT TIN, PLATED WITH 120 μ THICK.
OVER 50 μ THICKNESS Ni.
(S) TIN, PLATED WITH 120 μ THICK,
OVER 100 μ THICKNESS Cu.
(N) NICKEL, PLATED WITH 120 μ THICK,
OVER 100 μ THICKNESS Cu.

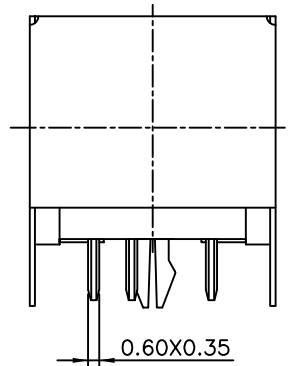
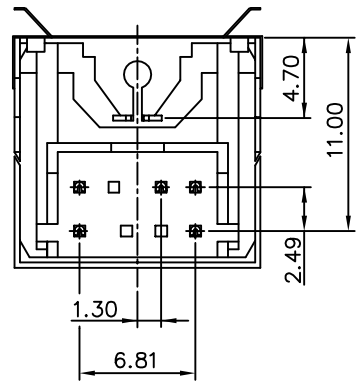

尚益科技有限公司
JMISCONN TECHNOLOGY CO., LTD.

PROJ		SCALE : F DO NOT SCALE DWG	MOLD NO 30025-5-03
APP			MODEL
CHK	CCJ	91.01.16	FILE NO
DGN	AMY	91.01.16	REV. X1
DRW	SHIEH	91.01.16	UNIT
			MM
			SHT 1 OF 1
			SIZE A4