

1 2 3 4 5 6 7

A

1.27*1.27 mm Dual Row/SMT Type

$0.38 + 1.27 \times \text{No. of Positions} \pm 0.3$

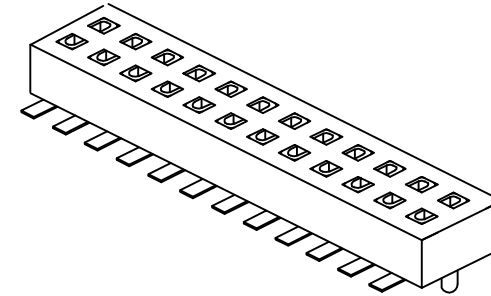
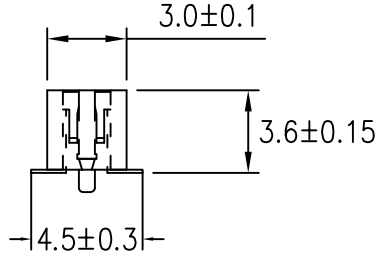
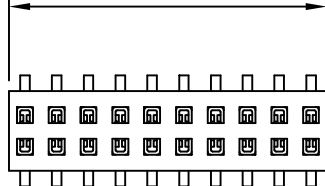

A

B

B

P.C.B LAYOUT

C

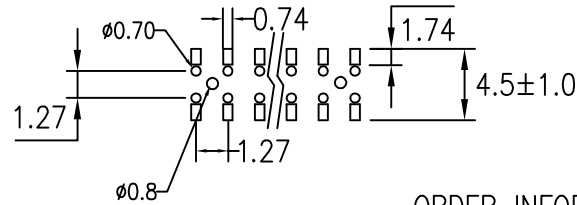
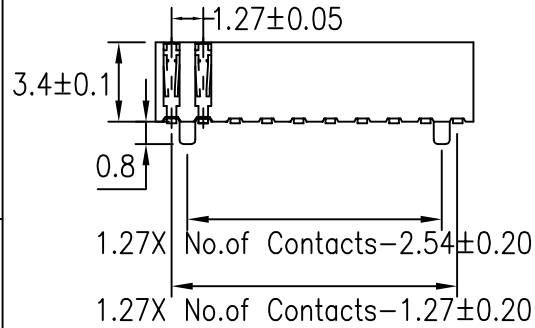

ORDER INFORMATION:

12703- 2X ?? -HS -D1 -G -0

- 0:W/O Locating Pegs
- I:With Locating Pegs
- Contact Plating:G:Gold Fflash
- Height:D1:3.4mm
- HS:SMT Type
- No of Contacts 3~50

C

D

D

SPECIFICATIONS
 CURRENT RATING:1AMP
 INSULATOR RESISTANCE:5000MΩMIN
 DIELECTRIC WITHSTANDING:AC 500V
 OPERATING TEMPERATURE:-40°C~+105°C
 MAX PROCESSING TEMP:230° for 30SECONDS
 CONTACT MATERIAL:PHOSPHOR BRONZE OR BRONZE
 INSULATOR MATERIAL:POLYESTER UL94V-0 LCP

FINISH:GOLD FLASH

尚益科技有限公司

JMSCONN TECHNOLOGY CO., LTD.

PROJ		SCALE : F DO NOT SCALE DWG	MOLD NO 12703		
APP			MODEL	FILE NO	REV. X1
CHK			UNIT	SHT 1 OF 1	SIZE A4
DGN			MM		
DRW	HSIEH	2012.07.20			

E

E

1 2 3 4 5 6 7